

RUA CEL: SALUSTIANO

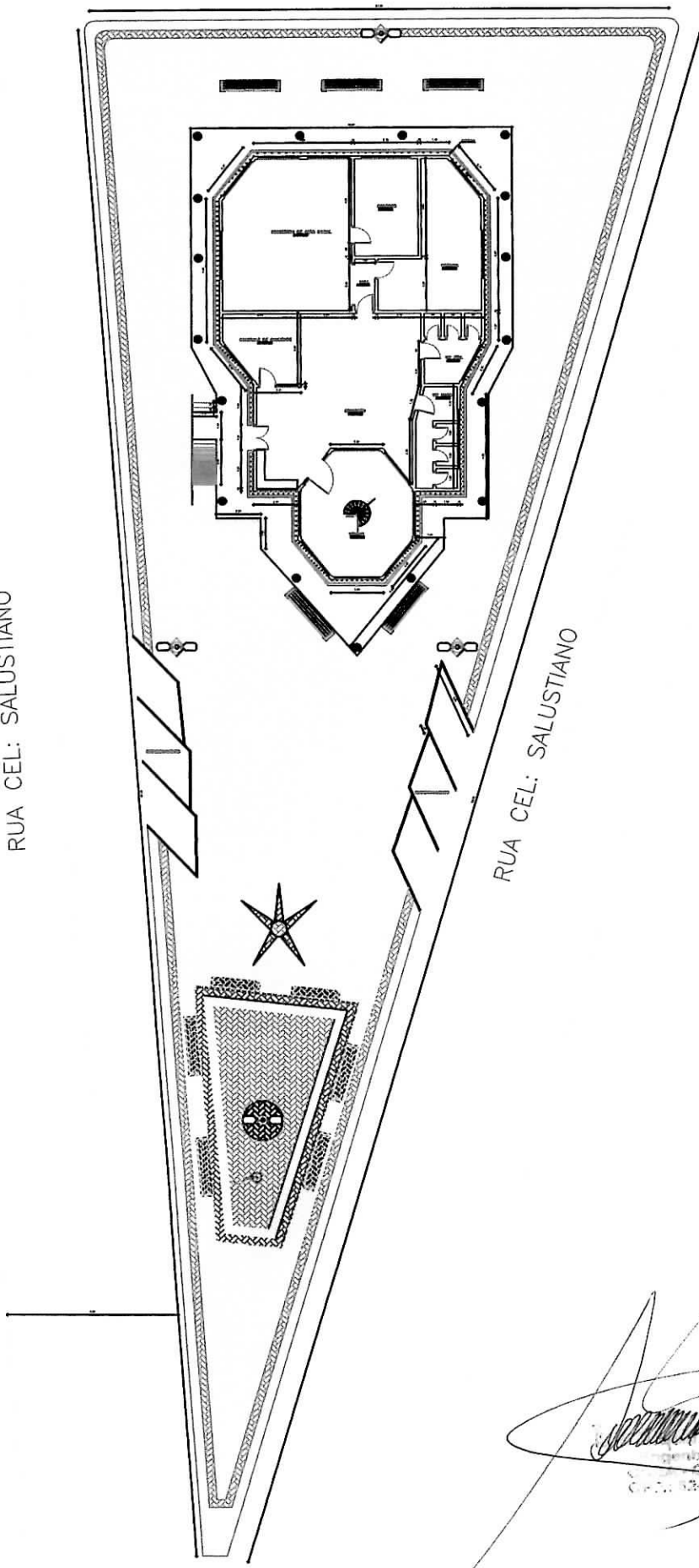

RUA CEL: SALUSTIANO

[Handwritten signature]
SECRET
OFFICE OF THE
DIRECTOR OF THE
CENTRAL INTELLIGENCE AGENCY

[Handwritten initials]

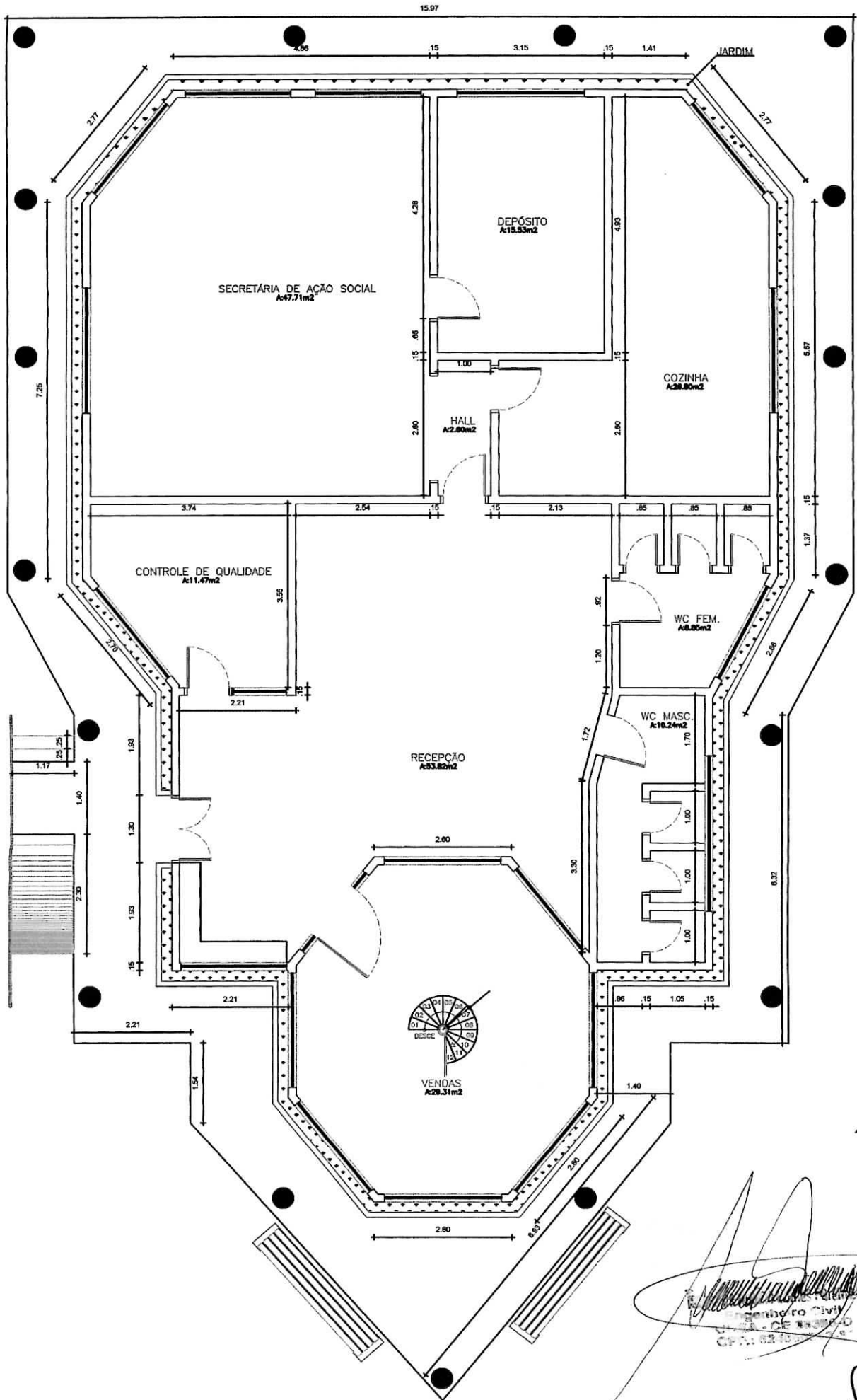

Handwritten signatures and stamps are present in the bottom right corner of the document.

Stamp: **Projeto de Engenharia**
Engenheiro Civil
CPF: 02.101.101-01

Handwritten signature: *[Signature]*

Handwritten initials: *[Signature]*